

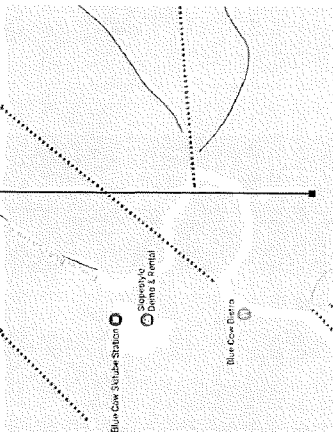

PROPOSED OPTUS  
SITE S3176

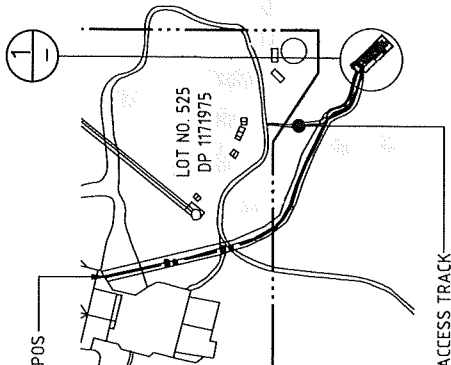

LOCALITY MAP  
COPYRIGHT © GOOGLE MAPS



OVERALL SITE PLAN

NTS COPYRIGHT © GOOGLE MAPS

**NOTE:**  
THIS DRAWING IS DIAGRAMMATIC ONLY  
AND SHOULD NOT BE SCALED.  
DIMENSIONS, COORDINATES, AND LEVELS  
SHOWN ARE NOMINAL AND SUBJECT TO  
CONFIRMATION BY SURVEYOR.

**SITE ADDRESS:**

SKITUBE TERMINAL  
BLUE COW KOSCIUSZKO NATIONAL PARK, NSW 2624

**NOTES:**

1. BASIS OF DESIGN  
> SITE INSPECTION 17/05/2017
2. PANEL ANTENNAS  
> 1-OFF PER SECTOR (EACH 2.6m LONG) AT EL 13.7m  
> SECTOR 1 - 40°, SECTOR 2 - 150°, SECTOR 3 - 260°  
> MOUNTED ON PROPOSED FACE MOUNT
3. TRANSMISSION  
> VIA OPTUS OPTIC FIBRE  
> TO BE CONFIRMED BY OPTUS
4. EQUIPMENT SHELTER  
> ELEVATED OPTUS ZONECOOL EQUIPMENT SHELTER  
> (3.15m x 2.38m), COLOURED "PALE EUCALYPT" WITH  
> PITCHED ALPINE ROOF
5. TELSTRA LATTICE TOWER  
> 20.75m HIGH LATTICE TOWER WITH PROPOSED FACE  
> MOUNT AT EL 13.7m
6. FEEDER CABLES  
> SIZE: HYBRID TRUNK CABLES (1 OFF) (MLEH 6/12)  
> AND (1 OFF) (MLEH 9/18) (SHARED BETWEEN ALL  
> SECTORS)

7. LENGTH: 20.00m ALL SECTORS  
> OTHER DETAIL NOT SHOWN ON PLAN
8. SITE ACCESS  
> OFF PERISHER BLUE COW LINK ROAD

**NSW**  
**Planning & Environmental**  
**ASSESSMENT**

ISSUED under the *Environmental Planning and Assessment Act 1979*

9. POWER SUPPLY  
> 3 PHASE, 32 AMPS
10. OTHER (PAINTING, LANDSCAPING, SCREENING)  
> N/A

Approved Application No. 2017/000119

granted on the 21/10/19

Signed: [Signature]

Approved Application No. 2017/000119

granted on the 21/10/19

Signed: [Signature]

Approved Application No. 2017/000119

granted on the 21/10/19

Signed: [Signature]

Approved Application No. 2017/000119

granted on the 21/10/19

Signed: [Signature]

Approved Application No. 2017/000119

granted on the 21/10/19

Signed: [Signature]

Approved Application No. 2017/000119

granted on the 21/10/19

Signed: [Signature]

Project: MOBILE NETWORK  
AUSTRALIA  
SITE NO: S3176 - A  
BLUE COW  
SKI TUBE TERMINAL BLUE COW

**OPTUS**



HUAWEI TECHNOLOGIES (AUSTRALIA) LTD  
91, 111, 133, 155  
DOWLING STREET, SYDNEY, NSW 2008  
AUSTRALIA  
TEL: +61 2 911 9100  
FAX: +61 2 911 9101  
WWW.HUAWEI.COM.AU

Rev	Date	Issued For	By	Check	Drawn	Checked	Scale	Author
01	18/04/19	ISSUED FOR APPROVAL						

COPYRIGHT © OPTUS MOBILES PTY LTD ABN 65 054 365 696. ALL RIGHTS RESERVED. VERSION 2.0 NOVEMBER 2013

Ref 2

NOTE:  
THIS DRAWING IS DIAGRAMMATIC ONLY  
AND SHOULD NOT BE SCALED.

NOTE:  
EXISTING ANTENNAS AS SHOWN ARE INDICATIVE  
ONLY AND ARE BASED ON INFORMATION SUPPLIED  
BY OTHERS AND/OR BY INSPECTION ON SITE.

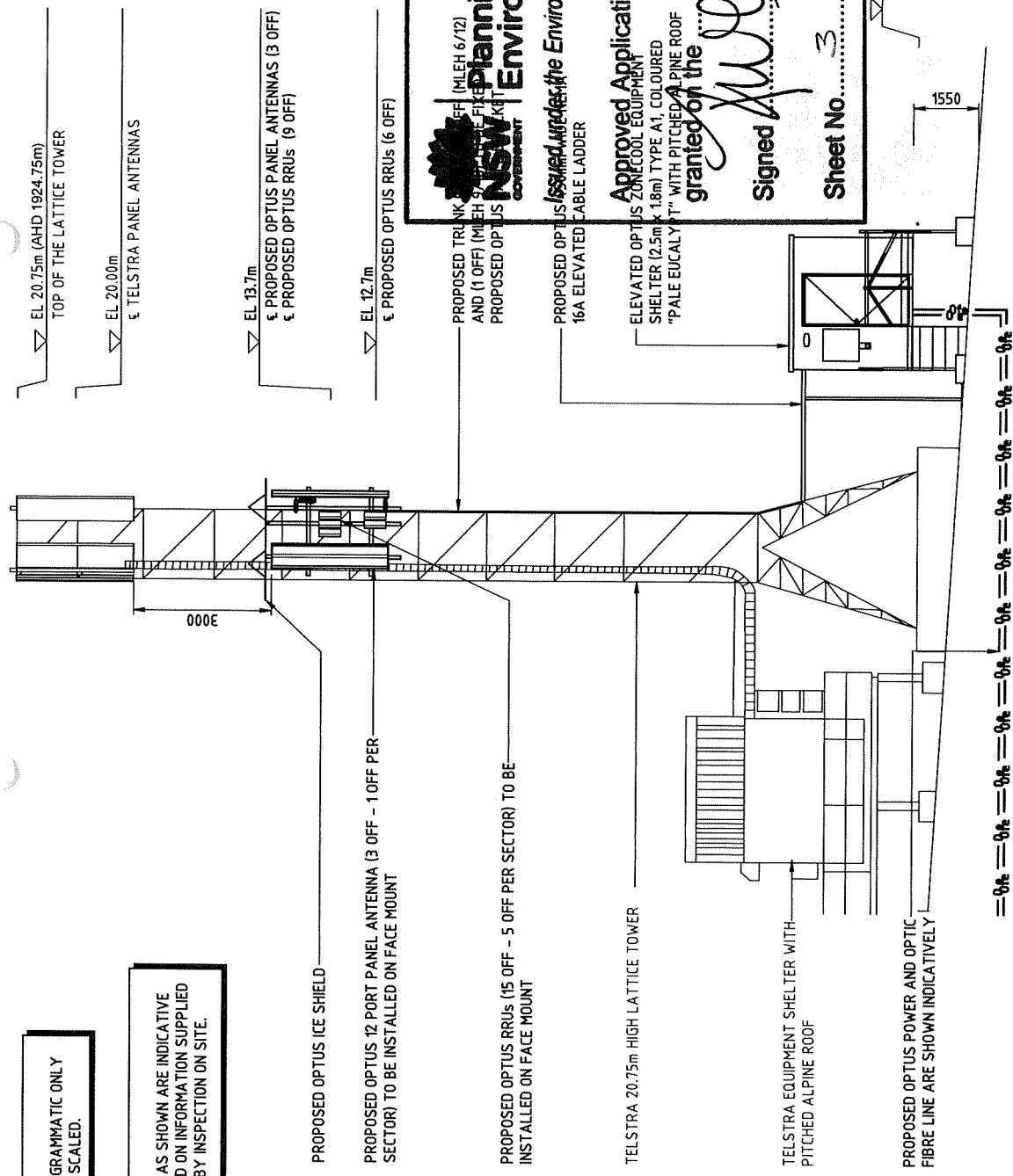

**SOUTH WESTERN ELEVATION**  
1:100

**Planning & Environment**  
NSW Government

**Approved Application No. 9917**  
granted on the 30/1/19

Signed *[Signature]*

Sheet No. 3 of 8

ISSUED under the Environmental Planning and Assessment Act 1979

Project: <b>MOBILE NETWORK AUSTRALIA</b> SITE NO: S3176 - A BLUE COW SKI TUBE TERMINAL BLUE COW		Drawing Title: <b>DRAFT SITE ELEVATION</b>		Drawing No. <b>S3176-P2</b> Revision <b>01</b>	
Client: <b>HUAWEI TECHNOLOGIES (AU) PTY LTD</b> LEVEL 17 TOWER 3 TRYPACIFIC HOVARY 100 COLLEGE STREET MELBOURNE VIC 3000 TEL: +61 3 9585 9900 FAX: +61 3 9521 1515		<b>OPTUS</b>		Drawing Status: <b>FOR APPROVAL</b>	
Issued For Approval Rev. Date Approved By Checked By Drawn By	RVD Consultant CAD Designer Checker Drafter	PK Designer Checker Drafter	PK Designer Checker Drafter	PK Designer Checker Drafter	PK Designer Checker Drafter

3 Optus antennas on  
Rooftop

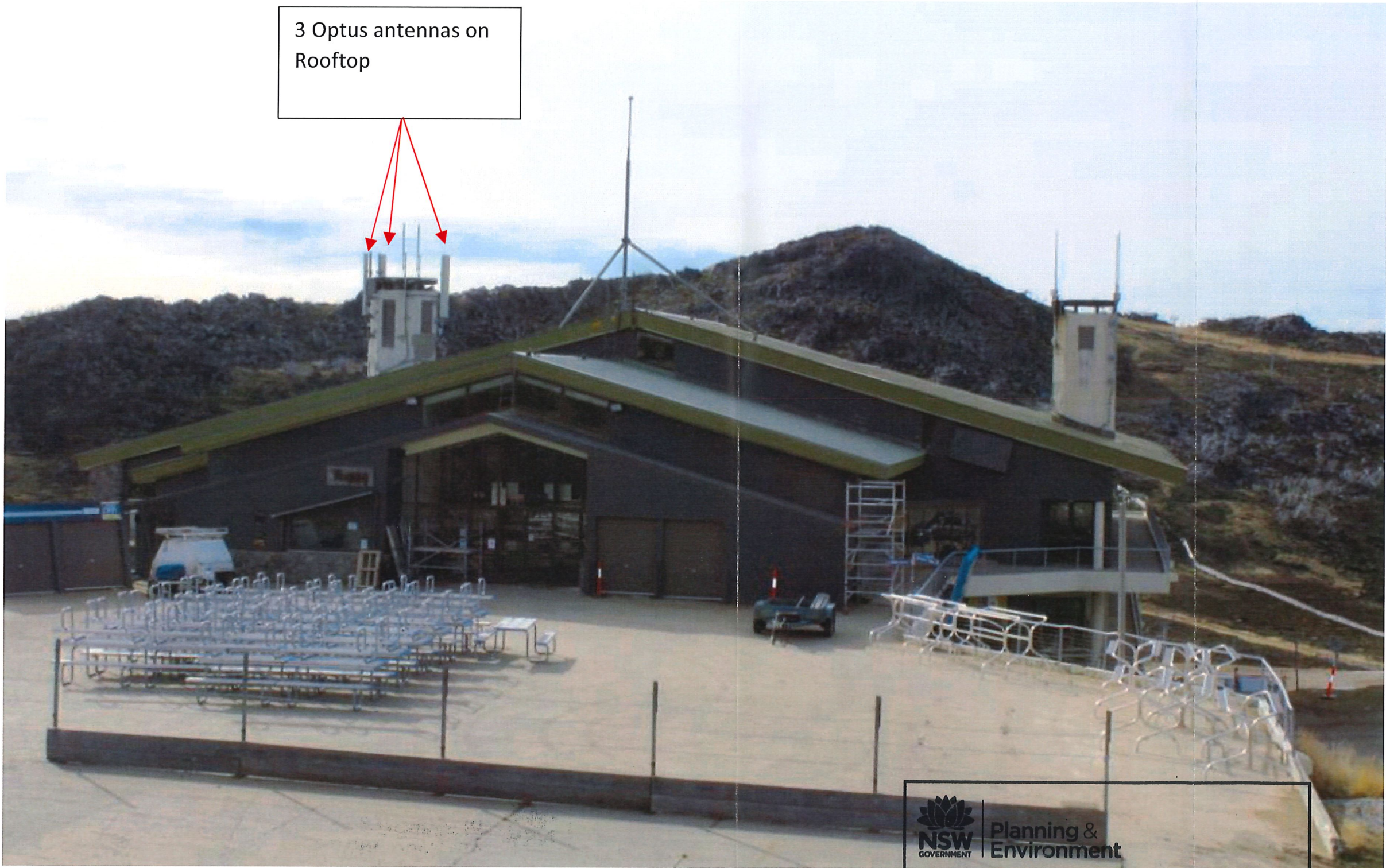

 **NSW**  
GOVERNMENT

**Planning &  
Environment**

Issued under the Environmental Planning and Assessment Act 1979

Approved Application No..... 9917 .....

granted on the ..... 31/10/19 .....

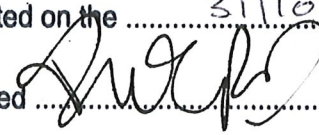
Signed .....  .....

Sheet No..... 8 ..... of ..... 8 .....